

BOOK ANT. 20 (BOW)
BOOK ANT. 24 (BOW)
JTW. ANT. 12 (BOW)
ANT. 10 (CAPS)

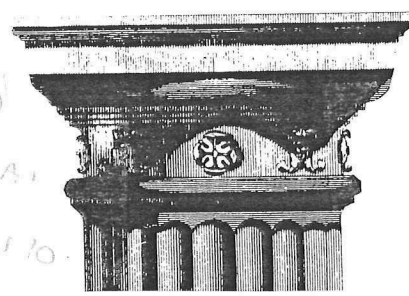

MUSEUM OPENS NEW EXHIBIT!



Thanks to a generous donation from Wilma O’Gara, the museum was able to construct a major exhibit in the new Bart and Wilma O’Gara Exhibit Case. Titled “Forks, Branches, and Prongs” this new exhibit discusses the structural differences between antlers, true horns, and the unique horns of the Pronghorn. The exhibit features the collections and research of Dr. Bart O’Gara. Do you know why the Pronghorn is unique in North America? Ever seen the inside of a Bighorn Sheep horn? Why do beetles have horns? Come see the exhibit and find out! An exhibit opening and reception is scheduled for Wed. February 2 at 4 PM on the first floor of the Health Sciences Building. Our guest of honor will be Wilma O’Gara.

This exhibit was constructed almost entirely by the museum’s intern and work-study graduate student, Jon Hardes. The exhibit case is housed where old, unused, and unsightly lockers once stood. The photo (right) shows the area before the case was installed. We hope this new exhibit will promote interest in building new such interesting exhibits in the Health Sciences Building!

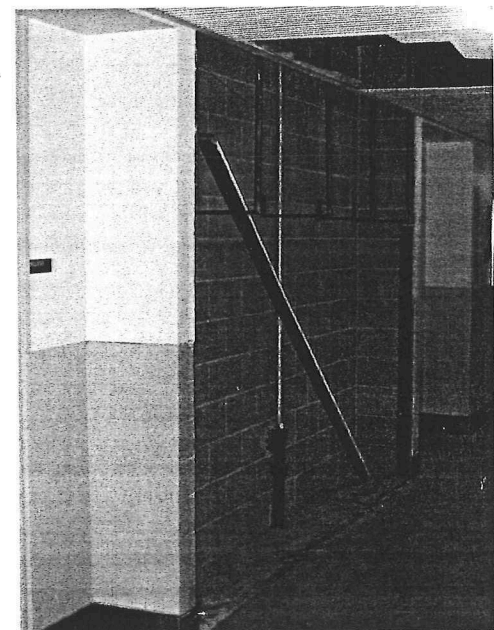

RECENT ACCESSIONS

Jeff Marks collected a **Swamp Sparrow** (*Melospiza georgiana*), which is the first record in the museum of this species since 1900, and a **Yellow-bellied Sapsucker** (*Sphyrapicus varius*), both from Westby in Sheridan Co., MT.

A collection of **small mammals**, mostly skulls of murids and shrews, from Medicine Lake National Wildlife Refuge was brought to the museum by Paul Hendricks of the MNHP. This collection was originally made by Elizabeth Madden.

The skull of an **Albatross** (*Diomedea* sp.) was transferred to the museum from the MT Natural History Center. The skull was found in 1976 in Australia.

Kate Davis brought in two falcons that did not survive in rehabilitation, a **Peregrine Falcon** (*Falco peregrinus*) from Great Falls and a **Prairie Falcon** (*Falco mexicanus*) from Stevensville. Kate also prepared both skins for the collection.

Our outstanding bird Skinner, Charles Miller, has recently collected and prepared a large number of birds for the teaching collection. These include a **Bank Swallow** (*Riparia riparia*), a **Sora Rail** (*Porzana carolina*), and a **Spotted Sandpiper** (*Actitis macularia*).

Thanks to the U.M. Anthropology Dept. for donating their complete disarticulated **Bison** (*Bos bison*) **skeleton** to the museum. This skeleton, known as BIF, or Bison Identification Facilitator, is the first complete bison skeleton in our collection and is already receiving extensive use by our graduate students in the museum conducting zooarchaeology research.

Meet the Staff! David Dyer - Curator; Jon Hardes - Assistant Curator & Museum Exhibit Intern; Charles Miller - Museum Preparation Lab & Head Volunteer; Becky Bigley, Shannon Gilbert - Research Associates. Phone - 243-4743.

Philip L. Wright Zoological Museum
Division of Biological Sciences
The University of Montana
Missoula, MT 59812
(MBii01)

